



Catalogue
CATERING
Chapter
OVENS

Model
 ACG-101 NG 230V 1N 60Hz

19011894

24/01/2019

ADVANCE CONCEPT INJECTION COMBI OVEN, ACG-102

Technology made simple :

Affordable
 Easy to use
 efficient
 Simple
 perfect results

Capacity for 10 2/1-GN trays or 20 1/1-GN trays.

Stainless steel burner with electronic control system with sparking plug ignition.

Frequency modulation for the convection burner.
 Digital push-button controls and two "Scroll" buttons.
 5 Cooking methods: Steam, Combi, Regeneration, Delta and Convection (up to 300°C).
 Steam generated by injection in the cooking chamber.
 Multisensor core temperature probe.
 Preheating option.
 3 Speeds - 2 power ranges.
 Cold-Down chamber cooling system.
 "Auto-reverse" system to reverse fan rotation.
 Error detection system. "Repair service" mode system.
 IPX5 Protection.
 AUTOMATIC CLEANING - Wash program for the cooking chamber.
 Door with double glass and hermetic locking and folding interior glass.

Electrical power: 1.2 kW.

Accessories in option:

Support SH-102
 Structure for trays EB-102
 Structure for dishes EP-102
 trolley CP-102
 External shower

DIMENSIONS

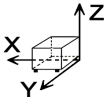

X Width	898 mm	X Gross width	980 mm
Y Depth	867 mm	Y Gross depth	1001 mm
Z Height	1117 mm	Z Gross height	1345 mm
Net Weight	163,0 kg	Gross Weight	194,0 kg
Net volume	0,870 m3	Gross volume	1,319 m3

ELECTRICITY TECHNICAL SPECIFICATIONS

Electric power	1,200 kW
Heating power	18,00 kW
Voltage	230V - 1N
Electric frequency	60Hz

GAS TECHNICAL SPECIFICATIONS

Gas type	NG
Gas power	18,00 kW
Regulated	NG G20 20 mbar

WATER TECHNICAL SPECIFICATIONS

Pressure	H2O: 200-400kPa(2-4bar)
----------	-------------------------



Catalogue
CATERING

Chapter
OVENS

Model
ACG-101 NG 230V 1N 60Hz

19011894

24/01/2019

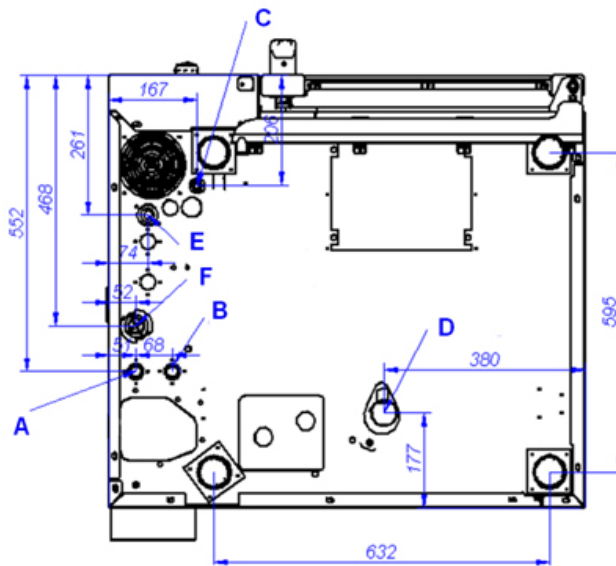
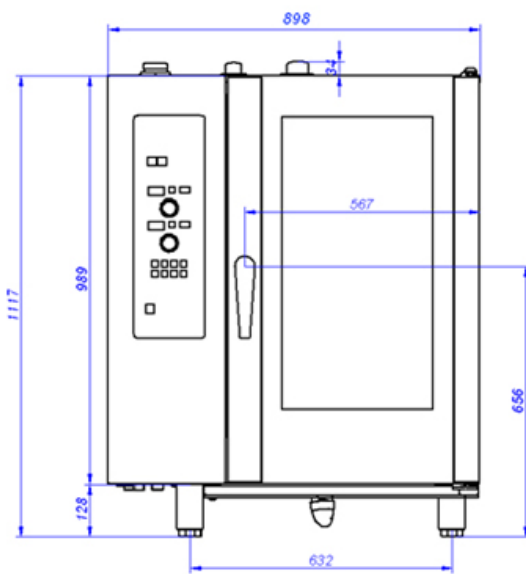

VISTA DE LA BASE DESDE LA PARTE INFERIOR
VIEW FROM THE BOTTOM OF THE MACHINE

ACG-101

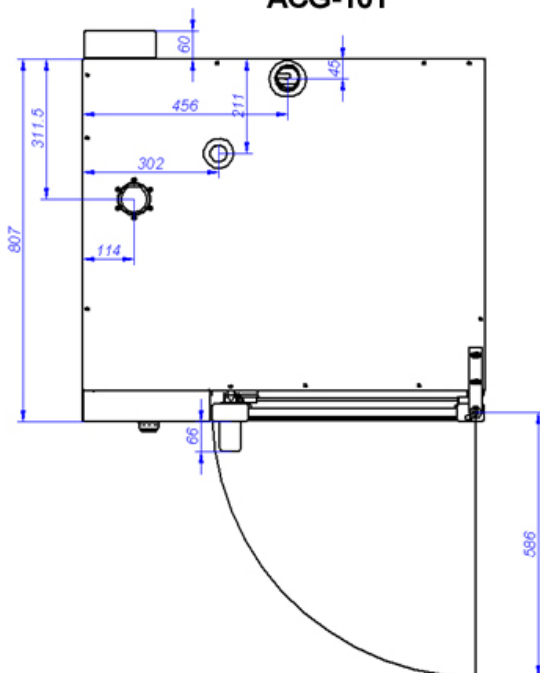

- A: Entrada de agua blanda
- B: Entrada de agua dura
- D: Desagüe
- C: Alimentación eléctrica
- E: Entrada de gas
- F: Entrada de aire
- A: Soft water inlet
- B: Water inlet
- D: Drain
- C: Electrical connection
- E: Gas inlet
- F: Air