



Catalogue
FOOD SERVICE
Chapter
REFRIGERATION

Model
ATA-101 230V 1N 60Hz

19030442

27/09/2019

BLAST CHILLER ATA-101

- Mixed models, for chiller blasting (+2 °C) or freezing cycles (-18 °C).
- There two working options both for chiller blasting and freezing:
 - Power cycle: for over 2 cm thick compact products.
 - Soft cycle: for less than 2 cm thick or low density products. The cycle is run in two programmed stages. The soft cycle prevents frost on the product.
- Cycle duration:
 - Refrigerating cycle: 90 minutes.
 - Freezing cycle: 240 minutes.
- Control panel with touch screen.
- Electronic programming of the cycles and core probe.
- The cycles can be controlled by time or by temperature according to the reading of the temperature sensor inside the product (time control is automatically applied when no probe is used).
- When the refrigerating cycle is over, the equipment works as a refrigerated cabinet, and the temperature remains between +2 and +4 °C, or as a freezer, with temperatures under -18 °C.
- Hermetically sealed compressor with ventilated condenser.
- Copper piping and aluminium flaps evaporator.
- Forced draught cooling system.
- Inner tray slides included.
- Automatic defrosting device activated by the user. Water evaporation device without power consumption.
- 60 mm injected polyurethane insulation. 40 kg/m³ density. CFC free.
- 10 Levels for GN-1/1 trays.
- 10 Levels for 60x40 trays.
- Production per refrigeration cycle = 50 kg
- Production per freezing cycle = 30 kg

Ordering options:

- Heated probe.
- USB connection for data extraction.
- "
- "

DIMENSIONS

X Width	900 mm	X Gross width	974 mm
Y Depth	935 mm	Y Gross depth	995 mm
Z Height	1766 mm	Z Gross height	1995 mm
Net Weight	171,0 kg	Gross Weight	180,0 kg
Net volume	1,486 m ³	Gross volume	1,933 m ³

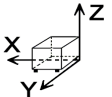

ELECTRICITY TECHNICAL SPECIFICATIONS

Electric power	2,000 kW
Voltage	230V - 1N
Amperage	8A
Electric frequency	60Hz

GAS TECHNICAL SPECIFICATIONS

Gas type	R-404A
----------	--------

COLD TECHNICAL SPECIFICATIONS

Refrigeration power	1,300 kW
Climate class	5
Cooling gas load	1000,000 g

CONNECTIONS TECHNICAL SPECIFICATIONS

Single-phase 230V wiring	2X1,5+T - 10 A
Drain 1 diameter	38



Catalogue
FOOD SERVICE

Chapter
REFRIGERATION

Model
ATA-101 230V 1N 60Hz

19030442

27/09/2019

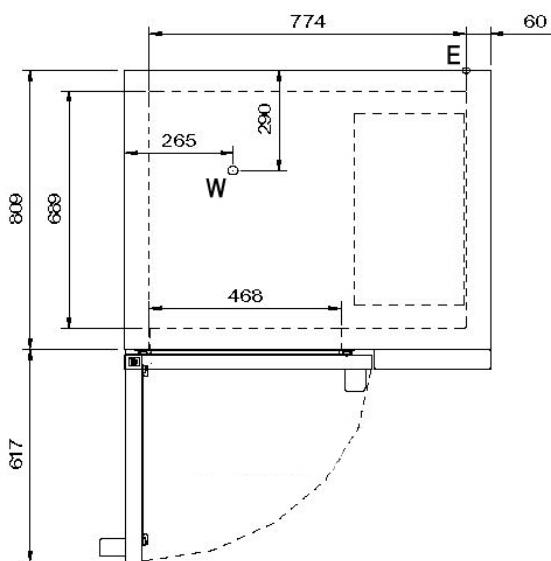
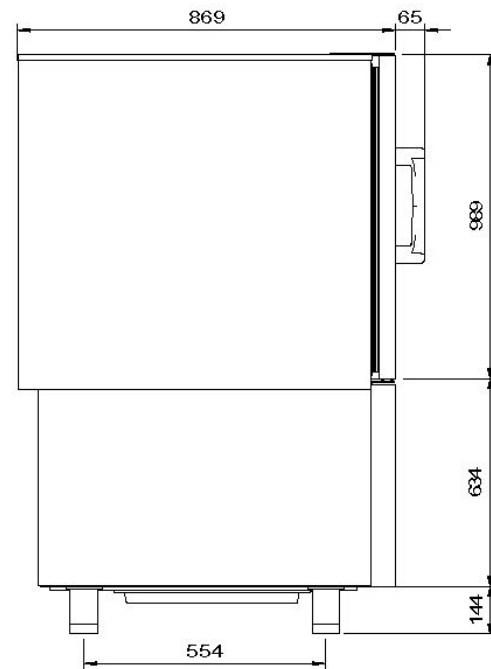
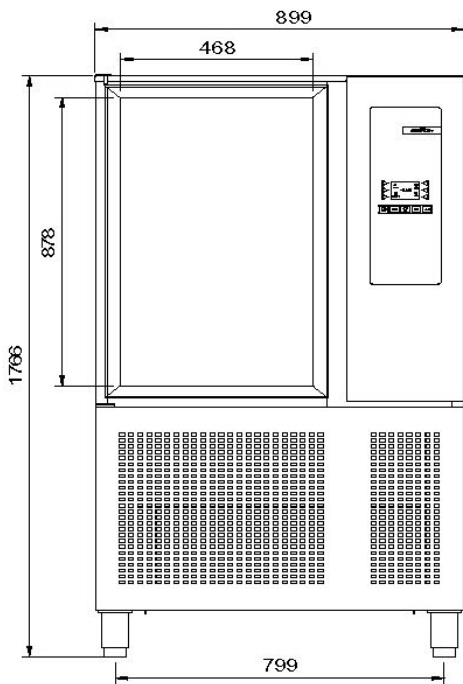

E : Toma eléctrica
Electrical connection

W: Toma de agua
Water inlet